

Department of Mechanical and Aerospace Engineering

FY2024 3rd ~ 9th Semester

Timetable

Information on lecture rooms

A### (A01), C### (A04), MM### (A05): Kawauchi Campus

M1-203: 2nd floor of Mechanical Engineering Research Building No.1 (A01), Aobayama East Campus

M2-213, M2-214, M2-215: 2nd floor of Mechanical Engineering Research Building No.2 (A03), Aobayama East Campus

Mech 1~8: 2nd floor of Mechanical Engineering Lecture Room Building (A02), Aobayama East Campus

Design Room: 2nd floor of Mechanical Engineering Research Building No.2 (A03), Aobayama East Campus

Computer Room: 3rd floor of Mechanical Engineering Research Building-M.A.E (A15), Aobayama East Campus

Laboratories for Students: 3rd floor of Mechanical Engineering Laboratories for Students-M.A.E (A07), Aobayama East Campus

Room 313, Room 314: 3rd floor of Administration Building, School of Engineering (C05), Aobayama East Campus

(Map)

Kawauchi Campus : https://www.tohoku.ac.jp/japanese/profile/campus/01/kawauchi/kawauchi_map_.pdf

Aobayama East Campus : <https://www.eng.tohoku.ac.jp/media/files/pdf/campusmap.pdf>

2024-2025 Academic Calendar

School of Engineering/General Education Subjects

2024	Sun	Mon	Tue	Wed	Thu	Fri	Sat
Apr.	...	1	2	3	4	5	6
	7	8	9	10	11	12	13
	14	15	16	17	18	19	20
	21	22	23	24	25	26	27
	28	29	30

May.	Sun	Mon	Tue	Wed	Thu	Fri	Sat
	1	2	3	4
	5	6	7	8	9	10	11
	12	13	14	15	16	17	18
	19	20	21	22	23	24	25
	26	27	28	29	30	31	...

Jun.	Sun	Mon	Tue	Wed	Thu	Fri	Sat
	1
	2	3	4	5	6	7	8
	9	10	11	12	13	14	15
	16	17	18	19	20	21	22
	23	24	25	26	27	28	29
	30
Jul.	Sun	Mon	Tue	Wed	Thu	Fri	Sat
	...	1	2	3	4	5	6
	7	8	9	10	11	12	13
	14	15	16	17	18	19	20
	21	22	23	24	25	26	27
	28	29	30	31

Aug.	Sun	Mon	Tue	Wed	Thu	Fri	Sat
	1	2	3
	4	5	6	7	8	9	10
	11	12	13	14	15	16	17
	18	19	20	21	22	23	24
	25	26	27	28	29	30	31

Sep.	Sun	Mon	Tue	Wed	Thu	Fri	Sat
	1	2	3	4	5	6	7
	8	9	10	11	12	13	14
	15	16	17	18	19	20	21
	22	23	24	25	26	27	28
	29	30

	Sun	Mon	Tue	Wed	Thu	Fri	Sat
Oct.	1	2	3	4	5
	6	7	8	9	10	11	12
	13	14	15	16	17	18	19
	20	21	22	23	24	25	26
	27	28	29	30	31

Nov.	Sun	Mon	Tue	Wed	Thu	Fri	Sat
	1	2
	3	4	5	6	7	8	9
	10	11	12	13	14	15	16
	17	18	19	20	21	22	23
	24	25	26	27	28	29	30

Dec.	Sun	Mon	Tue	Wed	Thu	Fri	Sat
	1	2	3	4	5	6	7
	8	9	10	11	12	13	14
	15	16	17	18	19	20	21
	22	23	24	25	26	27	28
	29	30	31

2025	Sun	Mon	Tue	Wed	Thu	Fri	Sat
	1	2	3	4
	5	6	7	8	9	10	11
	12	13	14	15	16	17	18
	19	20	21	22	23	24	25
	26	27	28	29	30	31	...

Feb.	Sun	Mon	Tue	Wed	Thu	Fri	Sat
	1
	2	3	4	5	6	7	8
	9	10	11	12	13	14	15
	16	17	18	19	20	21	22
	23	24	25	26	27	28	...

Mar.	Sun	Mon	Tue	Wed	Thu	Fri	Sat
	1
	2	3	4	5	6	7	8
	9	10	11	12	13	14	15
	16	17	18	19	20	21	22
	23	24	25	26	27	28	29
	30	31

Notice: _____ are normal classes or make-up classes, (dotted line) are intensive classes, _____ are Holiday,

(Thick line) are the boundary between the quarter

- : May.2 (Thu.) and Jan.29 (Wed.) is supplementary classes on Monday
Jan.28 (Tue.) is supplementary classes on Friday
Dec.26 (Thu.) is supplementary classes on Friday (General Education Subjects)

◇: Oct.14 (Mon) is National Holi day but there is school as usual.

※ Oct.25(Fri.) is University Festival (plans) is no class

※ Jan.17 (Fri.) is the National Center Test for University Admissions is no class (General Education Subjects)

Even during summer vacation and end of the term break, Intensive Lectures, Plant Visit, Graduation Thesis, Entrance exam, Commencement, etc. will be held.

In addition, sometimes re-test (supplementary test) may be carried out.

FY2024 School of Engineering Specialized Subject Class Schedule

Spring (1.3.5.7) Semester

April 1 (Mon.)-April 5 (Fri.), 2024 Spring Break

April 8 (Mon.)-August 5 (Mon.), 2024 Normal classes or makeup classes

(1Q: April 8 (Mon.)-June 3 (Mon.), June 6 (Thu.)- 7 (Fri.), 2024)

(2Q: June 4 (Tue.)- June 5 (Wed.), June 10 (Mon.) -August 5 (Mon.), 2024)

August 6 (Tue.), 2024 - Summer Vacation

Fall (2.4.6.8) Semester

October 1 (Tue.)-December 25 (Wed.), 2024 Normal classes or makeup classes

December 26 (Thu), 2024-January 3 (Fri.), 2025 Winter Break

January 6 (Mon.)-February 3 (Mon.), 2025 Normal classes or makeup classes

(3Q: October 1 (Tue.)-November 25 (Mon.), November 29 (Fri.) - December 2 (Mon.), 2024)

(4Q: November 26 (Tue.)-November 28 (Thu.), December 3 (Tue.), 2024-February 3 (Mon.), 2025)

February 4 (Tue.), 2025- Term-end Vacation

Notice

(1)May.2 (Thu.) is supplementary classes on Monday

Jan.28 (Tue.) is supplementary classes on Friday

Jan.29 (Wed.) is supplementary classes on Monday

Dec.26 (Thu.) is supplementary classes on Friday (General Education Subjects)

(2)Oct.14 (Mon) is National Holi day but there is school as usual.

(3)Even during summer vacation and end of the term

Entrance exam, Commencement, etc. will be held.

In addition, sometimes re-test (supplementary test) may be carried out.

Schedule for the Matriculation Ceremony etc.

Learning level certification system (category 1:Basic Test)	April 2 (Tue.), 2024 (Kawauchi Campus)
Guidance for IMAC-U	April 3 (Wed.), 2024 10:00~
Laboratory Assignment Guidance	April 3 (Wed.), 2024 11:15~
Regular Medical Checkups (All students)*	April 22 (Mon.)- 26 (Fri.), May 7 (Tue.) ~ 20 (Mon.), 2024
University Foundation Day	Jun1 22(Sat.), 2024
Open campus	July 30 (Tue.)-31 (Wed.), 2024
September Commencement Ceremony (Doctoral, Masters, Undergraduate)	September 25 (Wed.) 2024
Emergency training	October
University Festival	October 25 (Fri.)-27 (Sun.), 2024
March Commencement Ceremony (Doctoral, Masters, Undergraduate)	March 25 (Tue.), 2025

6. Map: Enlarged view of Area of Mechanical and Aerospace Engineering

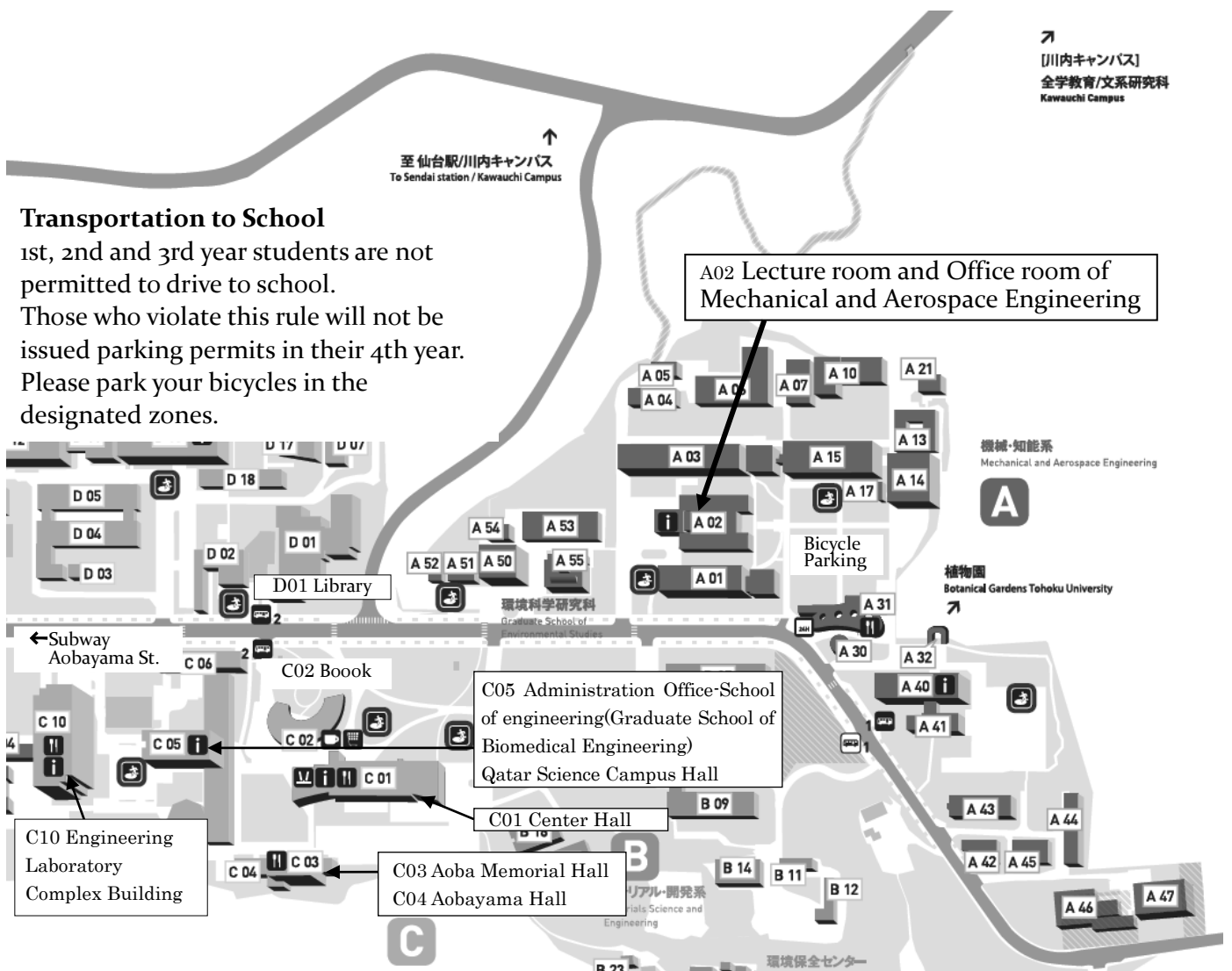

Mechanical and Aerospace Engineering

- A 01 Research Building No.1-M.E.
- A 03 Research Building No.2-M.E.
- A 02 Lecture Room Building-M.E.
- A 05 Research Laboratory I-M.E.
- A 04 Research Laboratory J-M.E.
- A 06 Research Laboratory Building
- A 07 Laboratories for Students-M.A.E.
Nano-Precision Machining Shop
- A 15 Research Building-M.A.E.
- A 10 Fracture Physics and Chemistry Research
Building Fracture and Reliability Research Institute
- A 14 Micromachining Facility
Micro/Nano-Machining Research and
Education Center
- A 17 Nanomachining Facility
- A 13 Nano-Biomedical Engineering Research Building
- A 21 Nano-Biomedical Engineering Research Laboratory

Common

- A 30 Automobile Museum
- A 31 Daily Yamazaki, Komorebi Cafe
- A 32 Botanical Gardens Tohoku University Aobayama Gate

Graduate School of Environmental Studies

- A 50 Research Building
- A 51 Lecture Room Building
- A 52 Geoscience Research Laboratory
- A 53 Research Laboratory
- A 54 Annex
- A 55 Ecollab.

Quantum Science and Energy Engineering

- A 40 Research Building
- A 41 Lecture Room Building
- A 43 Radioisotope Laboratory
- A 42 Research building of research center for
remediation engineering of living environments
contaminated with radioisotopes
- A 44 Integrated Laboratory for Advanced Fusion
Reactor Engineering
- A 45 Laboratory building of research center for
remediation engineering of living environments
contaminated with radioisotopes
- A 46 Fast Neutron Laboratory
- A 47 Subcritical Assembly

* Lecture room Building of Mechanical and Aerospace Engineering (Refer: Campus map A02)

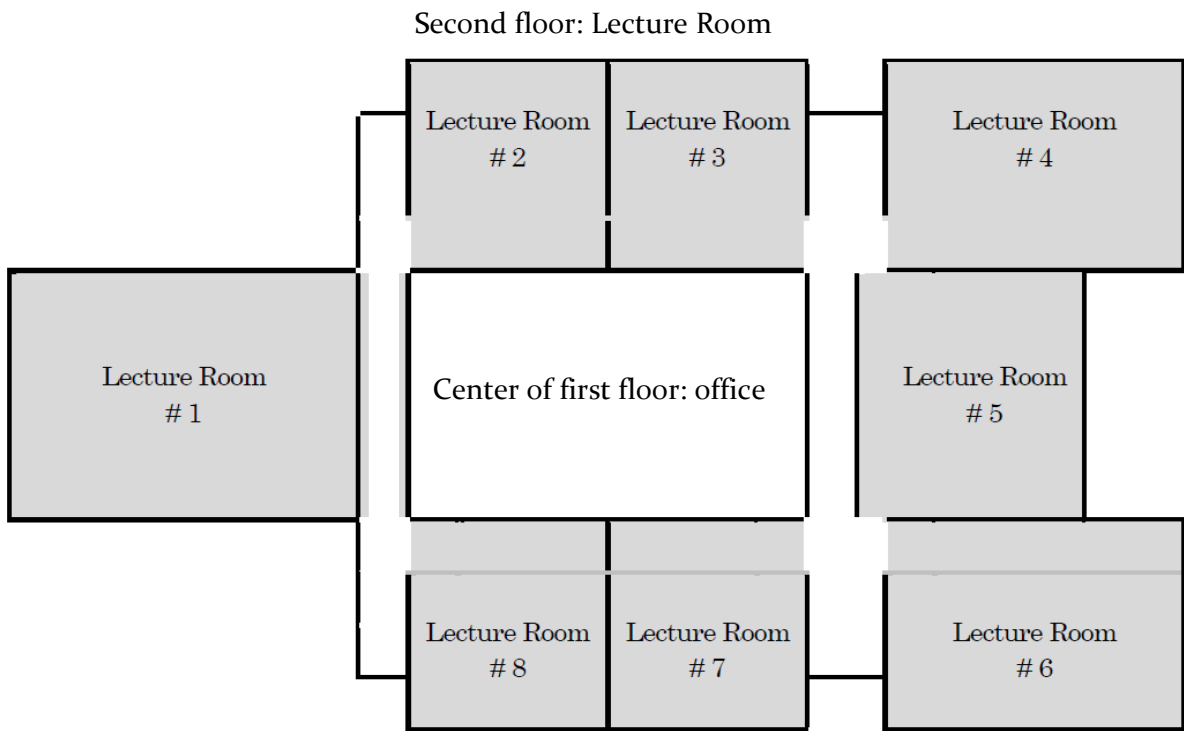

Research Building No 2. M.E.(Refer: Campus map A03)

2nd floor

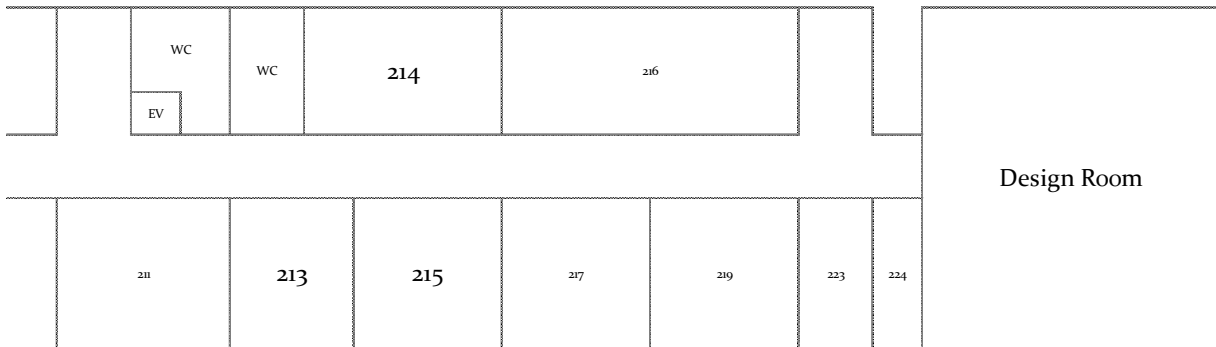

Research Building-M.A.E.(Refer: Campus map A15)

3rd floor

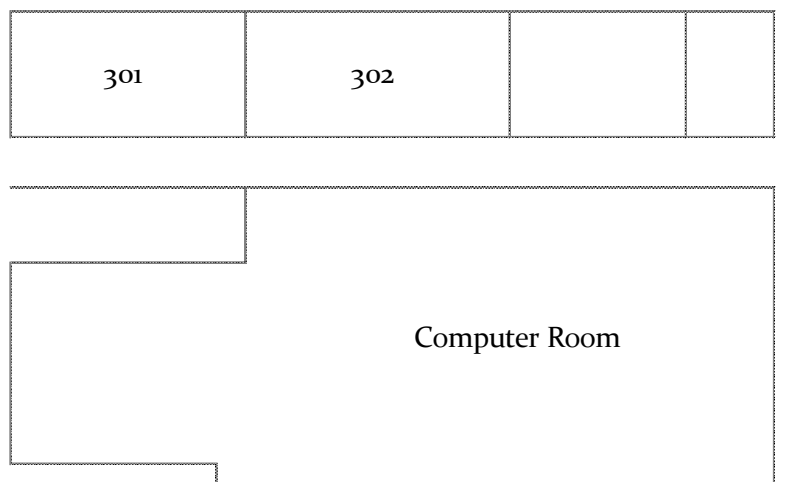

Mechanical and Aerospace Engineering 1 Quarter (3 Semester)

3S 1Q	8:50 to 9:35 a.m.	9:35 to 10:20 a.m.	10:30 to 11:15 a.m.	11:15 to 12:00 p.m.	1:00 to 1:45 p.m.	1:45 to 2:30 p.m.	2:40 to 3:25 p.m.	3:25 to 4:10 p.m.	4:20 to 5:05 p.m.	5:05 to 5:50 p.m.
Mon.			◎ TB13044 Mechanics Mon.2, Fri.1 [M2-214 (Bld. A03) Aobayama East] Anna Suzuki		◎ TB13014 Mathematics I Mon.3, Fri.3 [M2-214 (Bld. A03) Aobayama East] Masayuki Takahashi		◎ TB13061 Exercises in Computer-Aided Problem Solving Mon.4, Fri.4 [Computer Room (Bld. A15) Aobayama East] Takayuki Okatani, Hiraku Matsukuma			
Tue.	◎ CB32303 Basic Japanese II Tue.1, Wed.2, Thu.5 [A403 (Bld. A02) Kawauchi]	◎ CB22304 Calculus B Tue.2 [C203 (Bld. A04) Kawauchi] DAHAN Xavier			◎ TBA Sports A Tue.3					
Wed.	◎ CB31322 Physics C Wed.1 [R115 (Bld. A12) Kawauchi] Takeshi Koike	◎ CB32303 Basic Japanese II Tue.1, Wed.2, Thu.5 [A403 (Bld. A02) Kawauchi]			◎ CB33315 Chemistry C Wed.3 [R115 (Bld. A12) Kawauchi] Mott Derrick		◎ TB13101 Exercises in Mathematics and Physics II Wed.4 [C204 (Bld. A04) Kawauchi] Chen Ying			
Thu.			◎ CB42317 Physics B Thu.2 [R115 (Bld. A12) Kawauchi] Fedoryenko Dmytro		◎ CB43308 Introductory Science Experiments Thu.3-4 [Student Laboratories (Bld. A06) Kawacuhi] Norihiro Nakamura other et al.				◎ CB32303 Basic Japanese II Tue.1, Wed.2, Thu.5 [A403 (Bld. A02) Kawauchi]	
Fri.	◎ TB13044 Mechanics Mon.2, Fri.1 [C104 (Bld. A04) Kawauchi] Anna Suzuki	◎ CB52301 Linear Algebra B Fri.2 [C203 (Bld. A04) Kawauchi] Alecander Gavriluk			◎ TB13014 Mathematics I Mon.3, Fri.3 [M2-214 (Bld. A03) Aobayama East] Masayuki Takahashi		◎ TB13061 Exercises in Computer-Aided Problem Solving Mon.4, Fri.4 [Computer Room (Bld. A15) Aobayama East] Takayuki Okatani, Hiraku Matsukuma			

•◎Classes of semester subject ◎ Classes of quarter subject □Slots in white:Specialized Subjects ■Slots in yellow:General Education Subjects

Specialized Subject Classes are held on Aobayama East Campus, except "Excersized in Mathematics and Physics II" on Wednesdays and "Mechanics" on Friday.

* Sports A: Students will choose one of the sports activities on the first day of "Sports A". It's not required to wear sportswear or gym shoes on the first day. Things to bring: Writing utensils

Mechanical and Aerospace Engineering 2 Quarter (3 Semester)

3S 2Q	8:50 to 9:35 a.m.	9:35 to 10:20 a.m.	10:30 to 11:15 a.m.	11:15 to 12:00 p.m.	1:00 to 1:45 p.m.	1:45 to 2:30 p.m.	2:40 to 3:25 p.m.	3:25 to 4:10 p.m.	4:20 to 5:05 p.m.	5:05 to 5:50 p.m.	
Mon.	◎ TB13022 Mathematics II Mon.1, Fri.3 [M2-214 (Bld. A03) Aobayama East] Takashi Furusawa		◎ TB13034 Numerical Analysis Mon.2, Fri.4 [M2-213 (Bld. A03) Aobayama East] Kanjuro Makihara								
Tue	◎ CB32303 Basic Japanese II Tue.1, Wed.2, Thu.5 [A403 (Bld. A02) Kawauchi] Natsue Sugaya, Atsuko Uchiyama, Masako Hayashi		◎ CB22304 Calculus B Tue.2 [C203 (Bld. A04) Kawauchi] DAHAN Xavier		◎ TBA Sports A Tue.3						
Wed	◎ CB31322 Physics C Wed.1 [R115 (Bld. A04) Kawauchi] Takeshi Koike		◎ CB32303 Basic Japanese II Tue.1, Wed.2, Thu.5 [A403 (Bld. A02) Kawauchi] Natsue Sugaya, Atsuko Uchiyama, Masako Hayashi		◎ CB33315 Chemistry C Wed.3 [R115 (Bld. A04) Kawauchi] Mott Derrick		◎ TB13101 Exercises in Mathematics and Physics II Wed.4 [C204 (Bld. A04) Kawauchi] Chen Ying				
Thu		◎ CB42317 Physics B Thu.2 [R115 (Bld. A04) Kawauchi] Fedorynenko Dmytro		◎ CB43308 Introductory Science Experiments Thu.3-4 [Student Laboratories (Bld. A06) Kawacuhi] Norihiro Nakamura other et al.				◎ CB32303 Basic Japanese II Tue.1, Wed.2, Thu.5 [A403 (Bld. A04) Kawauchi] Natsue Sugaya, Atsuko Uchiyama, Masako Hayashi			
Fri		◎ CB52301 Linear Algebra B Fri.2 [C203 (Bld. A04) Kawauchi] Alecander Gavriyuk		◎ TB13022 Mathematics II Mon.1, Fri.3 [M2-214 (Bld. A03) Aobayama East] Takashi Furusawa		◎ TB13034 Numerical Analysis Mon.2, Fri.4 [M2-213 (Bld. A03) Aobayama East] Kanjuro Makihara					

•◎Classes of semester subject ◎ Classes of quarter subject □Slots in white:Specialized Subjects ■Slots in yellow:General Education Subjects

Specialized Subject Classes are held on Aobayama East Campus, except "Excersized in Mathematics and Physics II" on Wednesdays.

* Sports A: Students will choose one of the sports activities on the first day of "Sports A". It's not required to wear sportswear or gym shoes on the first day. Things to bring: Writing utensils

Mechanical and Aerospace Engineering 3 Quarter (4 Semester)

4S 3Q	8:50 to 9:35 a.m.	9:35 to 10:20 a.m.	10:30 to 11:15 a.m.	11:15 to 12:00 p.m.	1:00 to 1:45 p.m.	1:45 to 2:30 p.m.	2:40 to 3:25 p.m.	3:25 to 4:10 p.m.	4:20 to 5:05 p.m.	5:05 to 5:50 p.m.
Mon.	◎ TB14015 Quantum Mechanics Mon.1,Thu.1 [M2-214 (Bld. A03) Aobayama East] Wataru Yashiro	◎ TB14025 Mechanical Vibrations I Mon.2, Fri.2 [M2-214 (Bld. A03) Aobayama East] Mitsuhiro Hayashibe, Fedorynenko Dmytro	◎ TB14075 Mechanics of Materials I Mon.3, Thu.3 [M2-214 (Bld. A03) Aobayama East] Yuji Ichikawa, Yoichi Takeda							
Tue	◎ CB21401 Probability & Statistics Tue.2 [C204 (Bld. A04) Kawauchi]	◎ CB31409 Intermediate Japanese Tue.2, Wed.1-2 [C204 (Bld. A04) Kawauchi]	◎ CB23402 Ordinary Differential Equations Tue.3 [C404 (Bld. A04) Kawauchi] DAHAN Xavier	◎ TBA Science Technology and Industry in Japan Tue.5 [A204 (Bld. A02) Kawauchi]	◎ CB25208 Digital Entrepreneurship Seminar Tue.5 [C101 (Bld. A04) Kawauchi] Takeshi Koike					
Wed	◎ CB31409 Intermediate Japanese Tue.2, Wed.1-2 [C204 (Bld. A04) Kawauchi]		◎ TB14151 Seminar I Wed.3, Fri.3 [M2-214 (Bld. A03) Aobayama East]	◎ TB14131 Practice of Information Processing Wed.4-5 [MM104 (Bld. A05) Kawauchi] Makoto Hirota						
Thu	◎ TB14015 Quantum Mechanics Mon.1,Thu.1 [M2-214 (Bld. A03) Aobayama East] Wataru Yashiro	◎ TB14035 Thermodynamics I Thu.2, Fri.1 [M2-214 (Bld. A03) Aobayama East] Takashi Tokumasu, Akihiro Hayakawa	◎ TB14075 Mechanics of Materials I Mon.3, Thu.3 [M2-214 (Bld. A03) Aobayama East] Yuji Ichikawa, Yoichi Takeda							
Fri	◎ TB14035 Thermodynamics I Thu.2, Fri.1 [M2-214 (Bld. A03) Aobayama East] Takashi Tokumasu, Akihiro Hayakawa	◎ TB14025 Mechanical Vibrations I Mon.2, Fri.2 [M2-214 (Bld. A03) Aobayama East] Mitsuhiro Hayashibe, Fedorynenko Dmytro	◎ TB14151 Seminar I Wed.3, Fri.3 [M2-214 (Bld. A03) Aobayama East]	◎ CB54401 Health Fri.4 [C203 (Bld. A04) Kawauchi]						
Intensive courses	Team-based Engineering for Invention (創造工学研修): Instructor and student arrange and decide the schedule of this lesson.									

•◎Classes of semester subject ◎ Classes of quarter subject □Slots in white:Specialized Subjects ■Slots in yellow:General Education Subjects

Mechanical and Aerospace Engineering 4 Quarter (4 Semester)

4S 4Q	8:50 to 9:35 a.m.	9:35 to 10:20 a.m.	10:30 to 11:15 a.m.	11:15 to 12:00 p.m.	1:00 to 1:45 p.m.	1:45 to 2:30 p.m.	2:40 to 3:25 p.m.	3:25 to 4:10 p.m.	4:20 to 5:05 p.m.	5:05 to 5:50 p.m.
Mon.	◎ TB14161 Mechanics of Materials II Mon.1, Thu.1 [M2-214 (Bld. A03) Aobayama East] Takeshi Yamaguchi, Go Yamamoto	◎ TB14213 Control Engineering I Mon.2, Fri.2 [M2-214 (Bld. A03) Aobayama East] Dai Owaki	◎ TB14171 Fluid Mechanics I Mon.3, Thu.3 [M2-214 (Bld. A03) Aobayama East] Takehiko Sato							
Tue	◎ CB21401 Probability & Statistics Tue.2 [C204 (Bld. A04) Kawauchi]	◎ CB31409 Intermediate Japanese Tue.2, Wed.1-2 [C204 (Bld. A04) Kawauchi]	◎ CB23402 Ordinary Differential Equations Tue.3 [C404 (Bld. A04) Kawauchi] DAHAN Xavier	◎ TBA Science Technology and Industry in Japan Tue.5 [A204 (Bld. A02) Kawauchi]	◎ CB25208 Digital Entrepreneurship Seminar Tue.5 [C101 (Bld. A04) Kawauchi] Takeshi Koike					
Wed	◎ CB31409 Intermediate Japanese Tue.2, Wed.1-2 [C204 (Bld. A04) Kawauchi]		◎ TB14151 Seminar I Wed.3, Fri.3 [M2-214 (Bld. A03) Aobayama East]	◎ TB14097 Computer Seminar I Wed.4-5 [M2-214 (Bld. A03) Aobayama East] Students must complete "Computer Seminar I" in the early 5th semester of the following year (FY2025)						
Thu	◎ TB14161 Mechanics of Materials II Mon.1, Thu.1 [M2-214 (Bld. A03) Aobayama East] Takeshi Yamaguchi, Go Yamamoto	◎ TB14076 Materials Science I Thu.2, Fri.1 [M2-214 (Bld. A03) Aobayama East] kazuhisa Sato, Yuji Ichikawa	◎ TB14171 Fluid Mechanics I Mon.3, Thu.3 [M2-214 (Bld. A03) Aobayama East] Takehiko Sato							
Fri	◎ TB14076 Materials Science I Thu.2, Fri.1 [M2-214 (Bld. A03) Aobayama East] kazuhisa Sato, Yuji Ichikawa	◎ TB14213 Control Engineering I Mon.2, Fri.2 [M2-214 (Bld. A03) Aobayama East] Dai Owaki	◎ TB14151 Seminar I Wed.3, Fri.3 [M2-214 (Bld. A03) Aobayama East]	◎ CB54401 Health Fri.4 [C203 (Bld. A04) Kawauchi]						
Intensive courses	Team-based Engineering for Invention (創造工学研修): Instructor and student arrange and decide the schedule of this lesson.									

•◎Classes of semester subject ◎ Classes of quarter subject □Slots in white:Specialized Subjects ■Slots in yellow:General Education Subjects

Mechanical and Aerospace Engineering 1 Quarter (5 Semester)

5S 1Q	8:50 to 9:35 a.m.	9:35 to 10:20 a.m.	10:30 to 11:15 a.m.	11:15 to 12:00 p.m.	1:00 to 1:45 p.m.	1:45 to 2:30 p.m.	2:40 to 3:25 p.m.	3:25 to 4:10 p.m.	4:20 to 5:05 p.m.	5:05 to 5:50 p.m.
Mon	◎ TB15303 Electrical and Electronic Circuit I Mon.1, Thu.1 [M2-214 (Bld. A03) Aobayama East] Naoki Inomata									
	◎ TB15112 Theory of Elasticity Mon.1, Thu.1 [M2-213 (Bld. A03) Aobayama East] Go Yamamoto	◎ TB15124 Manufacturing Engineering and Technology I Mon.2, Thu.2 [M2-213 (Bld. A03) Aobayama East] Yoichi Takeda	◎ TB15204 Fundamentals of Information Science I Mon.3, Thu.3 [M2-213 (Bld. A03) Aobayama East] Hiroaki Kobayashi							
Tue	◎ TB15291 Materials Science II Tue.1, Fri.1 [M2-214 (Bld. A03) Aobayama East] Ken Suzuki	◎ TB15307 Mechanical Vibrations II Tue.2, Fri.2 [M2-214 (Bld. A03) Aobayama East] Masaya Toda								
Wed.							◎ TB14095 Computer Seminar I Wed.4-5 [M2-214 (Bld. A03) Aobayama East] Only students who have completed "Computer Seminar I" of the late 4th semester of the last year (FY2024) can take this lecture			
Thu.	◎ TB15303 Electrical and Electronic Circuit I Mon.1, Thu.1 [M2-214 (Bld. A03) Aobayama East] Naoki Inomata									
	◎ TB15112 Theory of Elasticity Mon.1, Thu.1 [M2-213 (Bld. A03) Aobayama East] Go Yamamoto	◎ TB15124 Manufacturing Engineering and Technology I Mon.2, Thu.2 [M2-213 (Bld. A03) Aobayama East] Yoichi Takeda	◎ TB15204 Fundamentals of Information Science I Mon.3, Thu.3 [M2-213 (Bld. A03) Aobayama East] Hiroaki Kobayashi							

Fri.	◎ TB15291 Materials Science II Tue.1, Fri.1 [M2-214 (Bld. A03) Aobayama East] Ken Suzuki	◎ TB15307 Mechanical Vibrations II Tue.2, Fri.2 [M2-214 (Bld. A03) Aobayama East] Masaya Toda	◎ TB15401 Design and Drawing I Fri.4-5 [M2-214 and Design Room (Bld. A03) Aobayama East] Yusuke Tamura
------	-------------------------------------------------------------------------------------------------------------	------------------------------------------------------------------------------------------------------------------	---------------------------------------------------------------------------------------------------------------------------

•◎Classes of semester subject ◎ Classes of quarter subject

Mechanical and Aerospace Engineering 2 Quarter (5 Semester)

5S 2Q	8:50 to 9:35 a.m.	9:35 to 10:20 a.m.	10:30 to 11:15 a.m.	11:15 to 12:00 p.m.	1:00 to 1:45 p.m.	1:45 to 2:30 p.m.	2:40 to 3:25 p.m.	3:25 to 4:10 p.m.	4:20 to 5:05 p.m.	5:05 to 5:50 p.m.	
Mon	◎ TB15362 Manufacturing Engineering and Technology II Mon.1, Thu.1 [M2-215 (Bld. A03) Aobayama East] Masayoshi Mizutani, Takeshi Yamaguchi	◎ TB15281 Electromagnetics Mon.2, Thu.2 [M2-214 (Bld. A03) Aobayama East] Takashiro Tsukamoto, Gael Sebald	◎ TB15212 Fundamentals of Information Science II Mon.3-4 [M2-214 (Bld. A03) Aobayama East] Masayuki Sato								
	◎ TB15363 Introduction to Aerospace Engineering Mon.1, Thu.1 [M2-213 (Bld. A03) Aobayama East]										
Tue.	◎ TB15074 Fluid Mechanics II Tue.1, Fri.1 [M2-213 (Bld. A03) Aobayama East] Kenichi Funamoto	◎ TB15024 Control Engineering II Tue.2, Fri.2 [M2-214 (Bld. A03) Aobayama East] Kazuya Yoshida									
Wed.											
Thu.	◎ TB15362 Manufacturing Engineering and Technology II Mon.1, Thu.1 [M2-215 (Bld. A03) Aobayama East] Masayoshi Mizutani, Takeshi Yamaguchi	◎ TB15281 Electromagnetics Mon.2, Thu.2 [M2-214 (Bld. A03) Aobayama East] Takashiro Tsukamoto, Gael Sebald									
	◎ TB15363 Introduction to Aerospace Engineering Mon.1, Thu.1 [M2-213 (Bld. A03) Aobayama East]										

Fri.	◎ TB15074 Fluid Mechanics II Tue.1, Fri.1 [M2-213 (Bld. A03) Aobayama East] Kenichi Funamoto	◎ TB15024 Control Engineering II Tue.2, Fri.2 [M2-214 (Bld. A03) Aobayama East] Kazuya Yoshida	◎ TB15401 Design and Drawing I Fri.4-5 [M2-214 and Design Room (Bld. A03) Aobayama East] Yusuke Tamura
------	-----------------------------------------------------------------------------------------------------------------	-------------------------------------------------------------------------------------------------------------------	---------------------------------------------------------------------------------------------------------------------------

Seminar II:

5 semester-late, "Seminar II" will be offered at each course from 13:00, so follow the instructions of your laboratory instructor and take classes on any day of the week.

IMAC-U TB16341

•◎Classes of semester subject ◎ Classes of quarter subject

Mechanical and Aerospace Engineering 3 Quarter (6 Semester)

6S 3Q	8:50 to 9:35 a.m.	9:35 to 10:20 a.m.	10:30 to 11:15 a.m.	11:15 to 12:00 p.m.	1:00 to 1:45 p.m.	1:45 to 2:30 p.m.	2:40 to 3:25 p.m.	3:25 to 4:10 p.m.	4:20 to 5:05 p.m.	5:05 to 5:50 p.m.
Mon.			◎TB16254 Machine Design I Mon.2, Fri.2 [M2-213 (Bld. A03) Aobayama East] Hiraku Matsukuma		◎ TB16114 Measurement and Instrumentation I Mon.3, Thu.1 [M2-213 (Bld. A03) Aobayama East] Wei Gao		◎ TB16261 Robotics I Mon.4, Fri.1 [M2-213 (Bld. A03) Aobayama East] Yasuhisa Hirata	Registration is not required Graduation Thesis Laboratory Laboratory faculty members		
Tue			◎TB16341 Seminar II [M2-214 (Bld. A03) Aobayama East]							
Wed					◎ TB16133 Laboratory Experiment II(Finemechnics) ◎TB16131 Laboratory Experiment II(Mechanical Systems)				Keiichi Shirasu Yuji Ichikawa	
Thu					◎ TB16114 Measurement and Instrumentation I Mon.3, Thu.1 [M2-213 (Bld. A03) Aobayama East] Wei Gao		◎ TB16136 Laboratory Experiment II(Aerospace Engineering)			Masayuki Takahashi
Fri			◎ TB16261 Robotics I Mon.4, Fri.1 [M2-213 (Bld. A03) Aobayama East] Yasuhisa Hirata	◎TB16254 Machine Design I Mon.2, Fri.2 [M2-213 (Bld. A03) Aobayama East] Hiraku Matsukuma	◎ TB16135 Laboratory Experiment (Robotics) ◎ TB16137 Laboratory Experiment (Mechanical/Biomedical Engineering)				Shinichiro Nomura Takeshi Okuyama	

• ◎Classes of semester subject ○ Classes of quarter subject

• In 6 semesters, "Graduation Thesis" will be conducted in each laboratory (3 hours per week). Be sure to check with the laboratory.

“Laboratory Experiment II” take courses for which you belong to the course.

Mechanical and Aerospace Engineering 4 Quarter (6 Semester)

6S 4Q	8:50 to 9:35 a.m.	9:35 to 10:20 a.m.	10:30 to 11:15 a.m.	11:15 to 12:00 p.m.	1:00 to 1:45 p.m.	1:45 to 2:30 p.m.	2:40 to 3:25 p.m.	3:25 to 4:10 p.m.	4:20 to 5:05 p.m.	5:05 to 5:50 p.m.
Mon.	◎ TB16192 Robotics II Mon.1, Thu.1 [M2-213 (Bld. A03) Aobayama East] Mitsuhiro Hayashibe	◎ TB16052 Computational Mechanics of Materials Mon.2, Thu.2 [M2-213 (Bld. A03) Aobayama East] Yoshiteru Aoyagi					◎ TB16312 Measurement and Instrumentation II Mon.4, Fri.2 [M2-213 (Bld. A03) Aobayama East] Gao Wei			
Tue										
Wed					◎ TB16133 Laboratory Experiment II(Finemechnics) Keiichi Shirasu ◎TB16131 Laboratory Experiment II(Mechanical Systems) Yuji Ichikawa					
Thu	◎ TB16192 Robotics II Mon.1, Thu.1 [M2-213 (Bld. A03) Aobayama East] Mitsuhiro Hayashibe	◎ TB16052 Computational Mechanics of Materials Mon.2, Thu.2 [M2-213 (Bld. A03) Aobayama East] Yoshiteru Aoyagi			◎ TB16136 Laboratory Experiment II(Aerospace Engineering) Masayuki Takahashi					
Fri		◎ TB16312 Measurement and Instrumentation II Mon.4, Fri.2 [M2-213 (Bld. A03) Aobayama East] Gao Wei			◎ TB16135 Laboratory Experiment (Robotics) Shinichiro Nomura ◎ TB16137 Laboratory Experiment (Mechanical/Biomedical Engineering) Takeshi Okuyama					

• ◎Classes of semester subject ◎ Classes of quarter subject

• In 6 semesters, "Graduation Thesis" will be conducted in each laboratory (3 hours per week). Be sure to check with the laboratory.

"Laboratory Experiment II"take courses for which you belong to the course.

Mechanical and Aerospace Engineering 1 Quarter (7 Semester)

7S 1Q	8:50 to 9:35 a.m.	9:35 to 10:20 a.m.	10:30 to 11:15 a.m.	11:15 to 12:00 p.m.	1:00 to 1:45 p.m.	1:45 to 2:30 p.m.	2:40 to 3:25 p.m.	3:25 to 4:10 p.m.	4:20 to 5:05 p.m.	5:05 to 5:50 p.m.
Mon.								◎ TB17391 Space Engineering Mon.4-5 [M2-214 (Bld. A03) Aobayama East] Kazuya Yoshida		
	◎ TB17292 Tribology Mon.1, Thu.1 [M2-215 (Bld. A03) Aobayama East] Takeshi Yamaguchi				◎ TB17421 Thermodynamics II Mon.3, Wed.2 Mech.8 Matsuhiko Nishizawa, Shinichiro Nomura	◎ TB17411 Biomechanical Engineering Mon.4, Wed.1 Mech.8 Yoichi Haga, Matsuhiko Nishizawa, Kenji Kikuchi, Kenichi Funamoto	Registration is not required Graduation Thesis Laboratory Laboratory faculty members			
Tue.		◎ TB17441 Energy Conversion System Engineering Tue.2, Fri.1 [M2-213 (Bld. A03) Aobayama East] Makoto Shimizu	Register in the column "その他 (Other) " TB17451 Laboratory Experiment I TB17461 Production Process Practice TB17471 Computer Seminar II *Details will be given at the guidance.							
Wed	◎ TB17411 Biomechanical Engineering Mon.4, Wed.1 Mech.8 Yoichi Haga, Matsuhiko Nishizawa, Kenji Kikuchi, Kenichi Funamoto	◎ TB17421 Thermodynamics II Mon.3, Wed.2 Mech.8 Matsuhiko Nishizawa, Shinichiro Nomura	Register in the column "その他 (Other) " TB17451 Laboratory Experiment I TB17461 Production Process Practice TB17471 Computer Seminar II *Details will be given at the guidance.							
Thu	◎ TB17292 Tribology Mon.1, Thu.1 [M2-215 (Bld. A03) Aobayama East] Takeshi Yamaguchi		Register in the column "その他 (Other) " TB17451 Laboratory Experiment I TB17461 Production Process Practice TB17471 Computer Seminar II *Details will be given at the guidance.							
Fri	◎ TB17441 Energy Conversion System Engineering Tue.2, Fri.1 [M2-213 (Bld. A03) Aobayama East] Makoto Shimizu		◎TB17431 Design and drawing II Fri.3-5 [M2-215 (Bld. A03) Aobayama East] Chen Ying, Fedorynenko Dmytro							

Laboratory Experiment I, Production Process Practice and Computer Seminar II class day								
subclass	Tue.		Wed.		Thu.		Fri.	
	Apr,May	Jun,Jul	Apr,May	Jun,Jul	Apr,May	Jun,Jul	Apr,May	Jun,Jul
機械系I	break	Production Process Practice	Laboratory Experiment I		break	Computer Seminar II	break	
機械系II	break		Computer Seminar II	break	Laboratory Experiment I		break	Production Process Practice
機械系III	Laboratory Experiment I		Production Process Practice	Computer Seminar II	break		break	
機械系IV	Laboratory Experiment I		break	Computer Seminar II	break		Production Process Practice	break
機械系V	break		Laboratory Experiment I		Production Process Practice	Computer Seminar II	break	
機械系VI	break		Computer Seminar II	Production Process Practice	Laboratory Experiment I		break	

→IMAC-U students subclass

(About the classroom) Laboratory Experiment I(See the texts), Production Process Practice(See the texts), Computer Seminar II(M2-214 (Bld. A03) Aobayama East)

• ㊦Classes of semester subject ㊦ Classes of quarter subject

• In 7 semesters, "Graduation Thesis" will be conducted in each laboratory (6 hours per week).

Please apply at the Academic Affairs section of Deptment of Mechanical and Aerospace Engineering when registering for Combustion Engineering(燃焼工学)

Mechanical and Aerospace Engineering 2 Quarter (7 Semester)

7S 2Q	8:50 to 9:35 a.m.	9:35 to 10:20 a.m.	10:30 to 11:15 a.m.	11:15 to 12:00 p.m.	1:00 to 1:45 p.m.	1:45 to 2:30 p.m.	2:40 to 3:25 p.m.	3:25 to 4:10 p.m.	4:20 to 5:05 p.m.	5:05 to 5:50 p.m.
Mon.					◎ TB17381 Electrical and Electronic Circuit II Mon.3, Wed.1 [M2-215 (Bld. A03) Aobayama East] Tetsu Tanaka		Registration is not required Graduation Thesis Laboratory Laboratory faculty members			
Tue.			◎ TB17282 English in Technology II Tue.2, Fri.2 Mech.7 Chen Ying		Register in the column "その他 (Other) " TB17451 Laboratory Experiment I TB17461 Production Process Practice TB17471 Computer Seminar II *Details will be given at the guidance.					
Wed.			◎ TB17371 Heat Transfer Wed.1-2 [M2-213 (Bld. A03) Aobayama East] Atsuki Komiya		Register in the column "その他 (Other) " TB17451 Laboratory Experiment I TB17461 Production Process Practice TB17471 Computer Seminar II *Details will be given at the guidance.					
			◎ TB17381 Electrical and Electronic Circuit II Mon.3, Wed.1 [M2-215 (Bld. A03) Aobayama East] Tetsu Tanaka							
Thu.					Register in the column "その他 (Other) " TB17451 Laboratory Experiment I TB17461 Production Process Practice TB17471 Computer Seminar II *Details will be given at the guidance.					
Fri.			◎ TB17282 English in Technology II Tue.2, Fri.2 Mech.7 Chen Ying		◎TB17431 Design and drawing II Fri.3-5 [M2-215 (Bld. A03) Aobayama East] Chen Ying, Fedorynenko Dmytro					

Laboratory Experiment I, Production Process Practice and Computer Seminar II class day								
subclass	Tue.		Wed.		Thu.		Fri.	
	Apr,May	Jun,Jul	Apr,May	Jun,Jul	Apr,May	Jun,Jul	Apr,May	Jun,Jul
機械系I	break	Production Process Practice	Laboratory Experiment I		break	Computer Seminar II	break	
機械系II	break		Computer Seminar II	break	Laboratory Experiment I		break	Production Process Practice
機械系III	Laboratory Experiment I		Production Process Practice	Computer Seminar II	break		break	
機械系IV	Laboratory Experiment I		break	Computer Seminar II	break		Production Process Practice	break
機械系V	break		Laboratory Experiment I		Production Process Practice	Computer Seminar II	break	
機械系VI	break		Computer Seminar II	Production Process Practice	Laboratory Experiment I		break	

→IMAC-U students subclass

(About the classroom) Laboratory Experiment I (See the texts), Production Process Practice (See the texts), Computer Seminar II (M2-214 (Bld. A03) Aobayama East)

- ㊦ Classes of semester subject ㊦ Classes of quarter subject
- In 7 semesters, "Graduation Thesis" will be conducted in each laboratory (6 hours per week).

Please apply at the Academic Affairs section of Department of Mechanical and Aerospace Engineering when registering for Combustion Engineering (燃焼工学)

Mechanical and Aerospace Engineering 3 Quarter (8 Semester)

8S 3Q	8:50 to 9:35 a.m.	9:35 to 10:20 a.m.	10:30 to 11:15 a.m.	11:15 to 12:00 p.m.	1:00 to 1:45 p.m.	1:45 to 2:30 p.m.	2:40 to 3:25 p.m.	3:25 to 4:10 p.m.	4:20 to 5:05 p.m.	5:05 to 5:50 p.m.
Mon	◎ TB18101 Aircraft design Mon.1, Wed.2 [M2-213 (Bld. A03) Aobayama East] Yuichi Kuya		Registration is not required Graduation Thesis Laboratory Laboratory faculty members							
	Tue.	◎ TB18091 Strength and Fracture of Materials Tue.1, Thu.2 [M2-213 (Bld. A03) Aobayama East] Kazuhiro Ogawa, Kazuhisa Sato		◎ TB18061 Heat and Mass Transfer Tue.2, Fri.1 Mech.5 Ken Suzuki		Registration is not required Graduation Thesis Laboratory Laboratory faculty members				
Wed.		◎ TB18071 Computational Fluid Dynamics Tue.1, Fri.2 [M2-215 (Bld. A03) Aobayama East] Takuji Ishikawa		◎ TB18081 Compressible Fluid Dynamics Tue.2, Thu.2 [M2-215 (Bld. A03) Aobayama East] Soshi Kawai		Registration is not required Graduation Thesis Laboratory Laboratory faculty members				
	Thu.	Registration is not required Graduation Thesis Laboratory Laboratory faculty members		◎ TB18101 Aircraft design Mon.1, Wed.2 [M2-213 (Bld. A03) Aobayama East] Yuichi Kuya		Registration is not required Graduation Thesis Laboratory Laboratory faculty members				
Thu.		Registration is not required Graduation Thesis Laboratory Laboratory faculty members		◎ TB18081 Compressible Fluid Dynamics Tue.2, Thu.2 [M2-215 (Bld. A03) Aobayama East] Soshi Kawai		Registration is not required Graduation Thesis Laboratory Laboratory faculty members				
	Thu.	Registration is not required Graduation Thesis Laboratory Laboratory faculty members		◎ TB18091 Strength and Fracture of Materials Tue.1, Thu.2 [M2-213 (Bld. A03) Aobayama East] Kazuhiro Ogawa, Kazuhisa Sato		Registration is not required Graduation Thesis Laboratory Laboratory faculty members				

Fri.	◎ TB18061 Heat and Mass Transfer Tue.2, Fri.1 Mech.5 Ken Suzuki	◎ TB18071 Computational Fluid Dynamics Tue.1, Fri.2 [M2-215 (Bld. A03) Aobayama East] Takuji Ishikawa	Registration is not required Graduation Thesis Laboratory Laboratory faculty members
------	------------------------------------------------------------------------------------	--------------------------------------------------------------------------------------------------------------------------	------------------------------------------------------------------------------------------------------

•◎Classes of semester subject ◎ Classes of quarter subject

Mechanical and Aerospace Engineering 4 Quarter (8 Semester)

8S 4Q	8:50 to 9:35 a.m.	9:35 to 10:20 a.m.	10:30 to 11:15 a.m.	11:15 to 12:00 p.m.	1:00 to 1:45 p.m.	1:45 to 2:30 p.m.	2:40 to 3:25 p.m.	3:25 to 4:10 p.m.	4:20 to 5:05 p.m.	5:05 to 5:50 p.m.
Mon.	Registration is not required Graduation Thesis Laboratory Laboratory faculty members									
Tue	Registration is not required Graduation Thesis Laboratory Laboratory faculty members	◎ TB18111 Machine Design II Tue.2, Fri.1 [M2-213 (Bld. A03) Aobayama East] Takafumi Fukushima	Registration is not required Graduation Thesis Laboratory Laboratory faculty members							
Wed	Registration is not required Graduation Thesis Laboratory Laboratory faculty members									
Thu	Registration is not required Graduation Thesis Laboratory Laboratory faculty members									
Fri	◎ TB18111 Machine Design II Tue.2, Fri.1 [M2-213 (Bld. A03) Aobayama East] Takafumi Fukushima	Registration is not required Graduation Thesis Laboratory Laboratory faculty members								

• ◎Classes of semester subject ◎ Classes of quarter subject

Mechanical and Aerospace Engineering 1-2 Quarter (9 Semester)

9S	8:50 to 9:35 a.m.	9:35 to 10:20 a.m.	10:30 to 11:15 a.m.	11:15 to 12:00 p.m.	1:00 to 1:45 p.m.	1:45 to 2:30 p.m.	2:40 to 3:25 p.m.	3:25 to 4:10 p.m.	4:20 to 5:05 p.m.	5:05 to 5:50 p.m.
Mon.	Registration is not required Graduation Thesis Labolatory Laboratory faculty members									
Tue	Registration is not required Graduation Thesis Labolatory Laboratory faculty members									
Wed	Registration is not required Graduation Thesis Labolatory Laboratory faculty members									
Thu	Registration is not required Graduation Thesis Labolatory Laboratory faculty members									
Fri	Registration is not required Graduation Thesis Labolatory Laboratory faculty members									

Web-based registration

Spring Semester (1 ▪ 3 ▪ 5 ▪ 7 Semester)

- First day of Spring Semester : Apr. 8 (Mon.)~
- Class Registration by website : Apr. 8 (Mon.)~Apr. 19 (Fri.), 2024
- Procedures for deregistering classes (1st Quarter) : Apr. 22 (Mon.)~May. 10 (Fri), 2024
- Procedures for deregistering classes (2nd Quarter) : Jun. 18 (Tue.)~Jun. 28 (Fri.), 2024

Fall Semester (2 ▪ 4 ▪ 6 ▪ 8 Semester)

- First day of Fall Semester : Oct. 1 (Tue.)~
- Class Registration by website : Oct. 1 (Tue.)~Oct. 14 (Mon.), 2024
- Procedures for deregistering classes (3rd Quarter) : Oct. 15 (Tue.)~Oct. 31 (Thu.), 2024
- Procedures for deregistering classes (4th Quarter) : Dec. 10 (Tue.)~Dec. 20 (Fri.), 2024

After the registration, confirmation/ revision period, it is unable to change registration.

If the course is not taken without requesting a cancellation, the student will receive a failing "D grade.